

17.2MM SIDE EMITTER SIDE EMITTER

Status	Production
Part no.	10267
Drawing no.	60465
Product type	Optic
Type	Side Emitter
Pieces	1
Diameter	17.2
Height	10.00
Beam	Side Emitter
Flange	No
Files	Customer drawing (PDF) Customer 3D model (.igs)

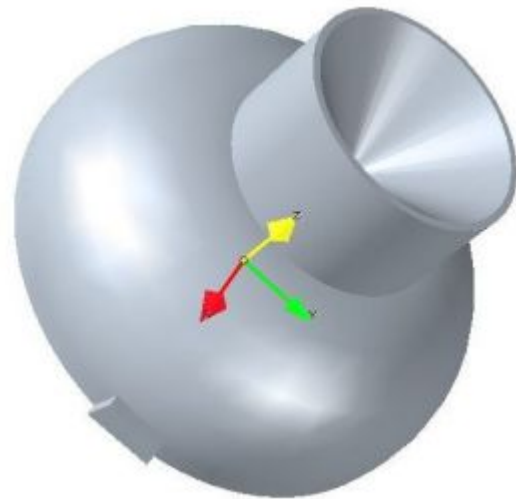

LEDs & Performances	Eff.	FWHM	Cd/lm	Spot	Cross-section	Files
Lumileds Rebel Cool White	87.0%	8.4	0.8			10267_rebel_wht_040309_model.IES

Carclo Technical Plastics endeavours to continuously improve and renew its products; for this reason the technical data and contents of this catalogue may undergo variations without prior notice. For correct and up to date information, Carclo suggest using the Opticselect tool on our website <http://www.carclo-optics.com>.
Copyright © Carclo 2010

Handling instructions

- Do not handle or install lenses without wearing gloves, skin oils may damage the lens or the light transmission.
- Clean lenses with a mild soap and water and dry with a clean soft cloth.
- Do not use any commercial solvents on lenses.
- Mount holders with low Odour epoxy's and allow time for them to out gas to stop lenses fogging.

Please note that flow lines, weld lines and small black or white inclusions within the lenses are acceptable if the optical performance of the lens is within the specification described to +/-10%. FWHM-Full (beam) Width as measured at one Half of Maximum intensity, information shown in the catalogue are based on our laboratory's tests.

All rights reserved. No part of this publication may be copied, reproduced in any form or by any means, electronic, mechanical, photocopying, recording or otherwise, illustrations not to be removed, without our prior permission. Carclo Technical Plastics reserves the right to make changes at any time in order to supply the best products possible.