

Overview

The SR-04 high brightness, side emitting LED modules features a single Rebel LED reflow soldered to our CoolBase PCB with a [Fraen F360L-3C-S](#) side emitting optic fastened to the base with Loctite 460 Adhesive.

The FR4 CoolBase features a highly efficient thermal design that matches or outperforms* standard aluminium MCPCB bases.

Connections to the base can be soldered using standard bench top tools and hand soldering techniques, making it easy to integrate this modules into fixtures or for use in OEM/MRO applications.

The SR-04 Side Emitting modules can be ordered directly from our website at www.luxeonstar.com/sr-04.



Construction

The base of this modules uses a specially designed 0.8mm, thermally conductive FR4 PCB that provides an unprecedented thermal conductivity rate of 1.5°C/W, which directly translates into:

- **Longer LED life**
- **Better color stability**
- **Reduced cooling requirements**

Features:

- Replacement option for the popular Luxeon Side Emitting LEDs
- Super efficient base design that matches or outperforms aluminium MCPCB bases
- Available with all currently produced Rebel LEDs
- RoHS compliant
- Pb free reflow soldered
- Extremely low thermal resistance
- Can be mounted with thermal tape

Module Specifications

Parameter	Value
Base Type	0.8mm FR4 PCB
Base Thermal Performance (Not including LED)	1.5°C/W
Finishing	Immersion Gold
Solder Mask Color	White
Solder Paste	AIM NC-258 No-Clean, Lead-Free
Max Operating Temperature (FR4 Base) ¹	95°C
Lens Adhesive	Loctite 460 Prism Instant Adhesive
Overall Dimensions (mm)	15.9L x 11W x 7.2H
Weight	0.8g

1. For maximum life, the FR4 board temperature must be kept below this value.

* Results will vary depending on the quality of the dielectric material used in the MCPCB base.

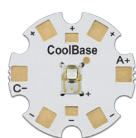

Power Drivers

The choice of power driver will depend on the Rebel LED that is mounted to the base, the number of LEDs being powered, the input voltage source and drive current. We offer a complete selection of compatible low and high voltage current regulated drivers on our website.

Mounting & Cooling

Use of this module requires careful attention to mounting and cooling to ensure that the junction temperature of the LED is kept well below the maximum rating as specified in the LED documentation published by Philips Lumileds.

For optimal cooling, we recommend that the module be mounted to a suitable heat sink (aluminum or copper) that is exposed to open air using a thermal interface material such as our [Bond-Ply® 100 pressure sensitive thermal tape](#) or [Arctic Silver™ thermal adhesive](#). The bottom of the LED module is electrically neutral, so it is not necessary to electrically isolate the LED base from the cooling surface.

Failure to ensure that the LED junction temperature is kept below its maximum temperature rating will result in poor color rendering, early degradation of light output, and premature LED failure!

Module Drawing

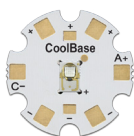
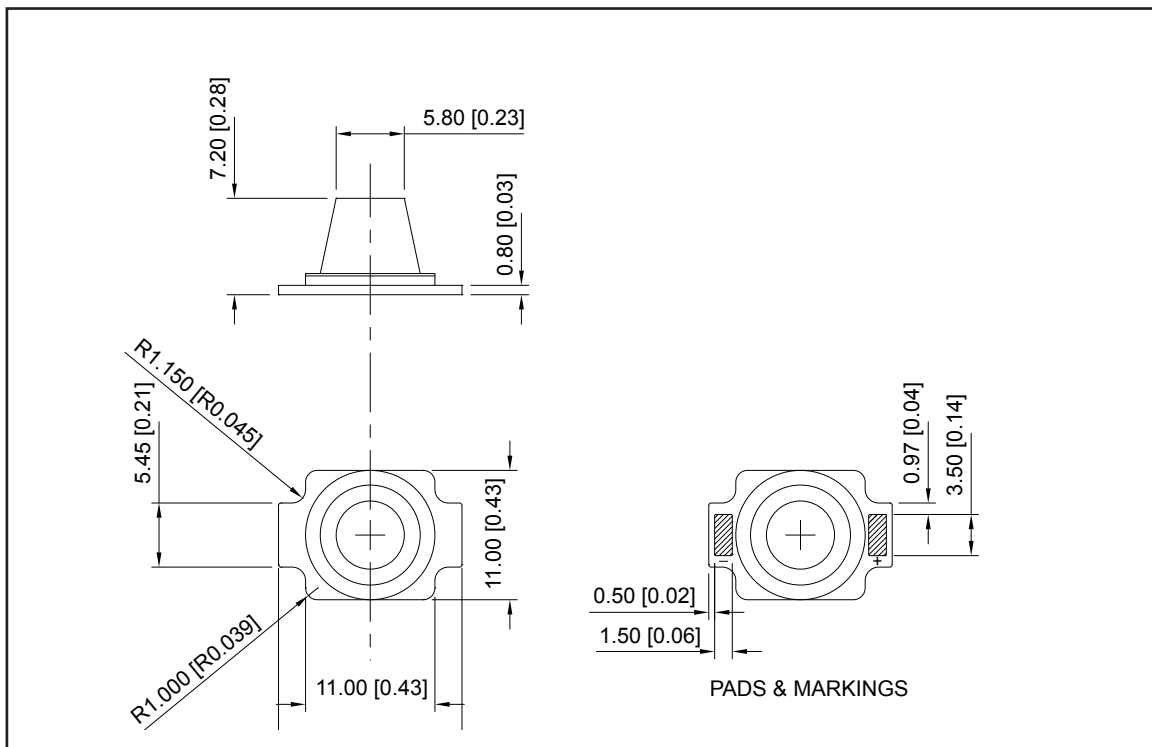

Safety:

The LED mounted onto this modules will produce a highly intense point of light. Do not stare directly at the LED for any length of time.

Restricted Use:

All products produced or sold by Quadica Developments Inc. are not certified for use as critical components in life support devices, systems, nor in medical operating room or life rescue equipment. A critical component is any component of a life support device, system or medical/rescue equipment whose failure to perform can be reasonably expected to cause failure or malfunction of the life support device, system or medical operating room/life rescue equipment.

Disclaimer:

Although QUADICA DEVELOPMENTS INC. has attempted to provide the most accurate information and services data (hereinafter "Data"), the Data is provided "as is" and may contain errors. The entire risk of use of the data shall be with the user. QUADICA DEVELOPMENTS INC. makes no warranty, express or implied, including, but not limited to, the implied warranties of merchantability and fitness for a particular purpose, regarding the contents or correctness of the Data provided or the ability of the Data to meet the user's needs or expectations. QUADICA DEVELOPMENTS INC. reserves the right to make changes and corrections without notice.

You as the user agree to this disclaimer and the user agreement with the download or use of the provided Data. In no event shall QUADICA DEVELOPMENTS INC. be liable for any direct, indirect, special, incidental, exemplary, or consequential damages arising out of or related to the use of the Data, however caused, regardless of theory of liability, and whether or not QUADICA DEVELOPMENTS INC. has been advised of the possibility of such damage. This limitation shall apply notwithstanding any failure of essential purpose or any exclusive remedy.

